



# ADDRESS MAP ZONING AND FLOODPLAINS

New Hope, MN

- R-1 - Single Family Residential
- R-2 - Single Two Family Residential
- R-3 - Medium Density Residential
- R-4 - High Density Residential
- R-5 - Senior/Disabled Residential
- R-O - Residential Office
- R-B - Residential Business
- R-PUD - Residential Planned Use Development
- LB - Limited Business
- CB - Community Business
- CC - City Center
- GPO - Governmental, Park & Open Space
- I - Industrial
- B-W - Business Warehouse
- PUD - Planned Use Development
- W - Water
- RR - Railroad
- Shoreland Overlay District
- 100 - Year Floodplain
- 500 - Year Floodplain
- Parcels
- Crystal Airport Zoning Limit
- Crystal Airport Safety Zone 2

## INSETS

Inset 1

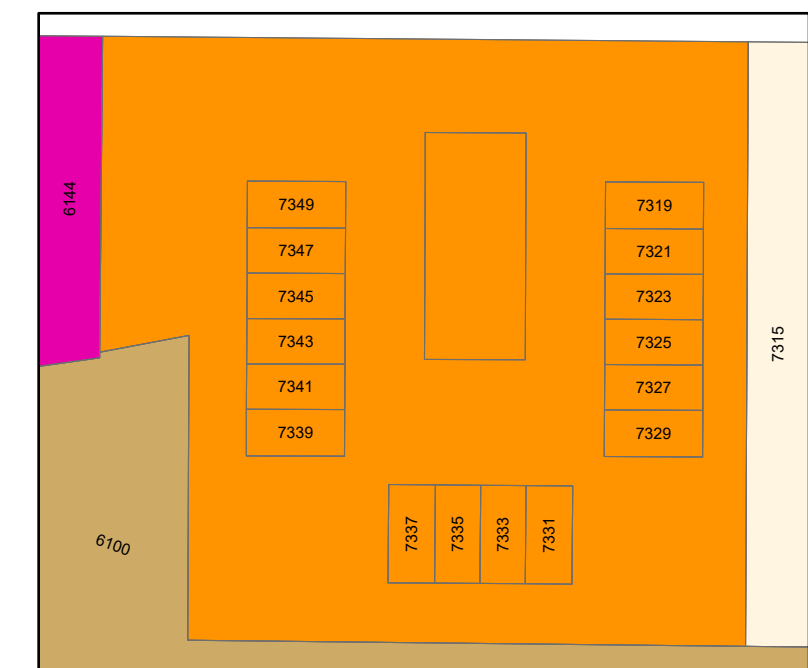

Inset 2

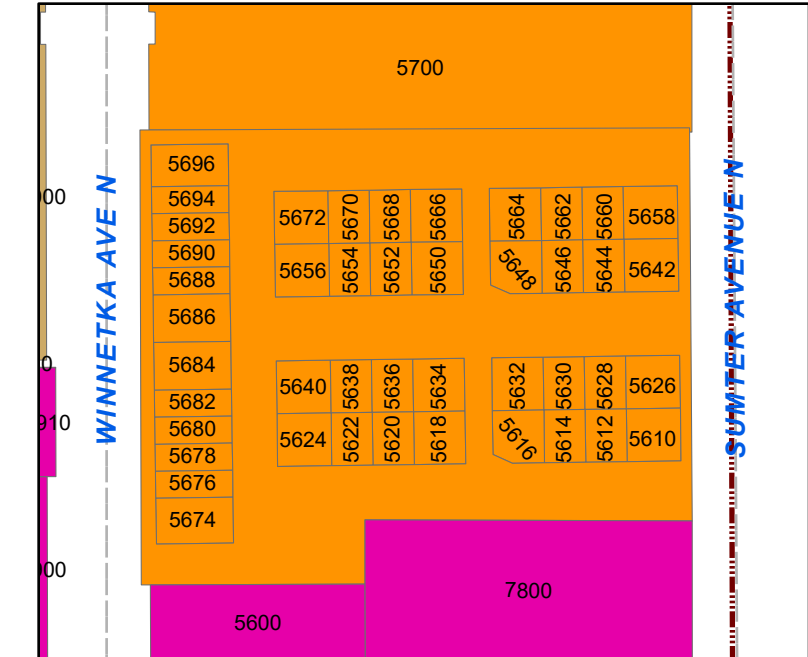

Inset 3

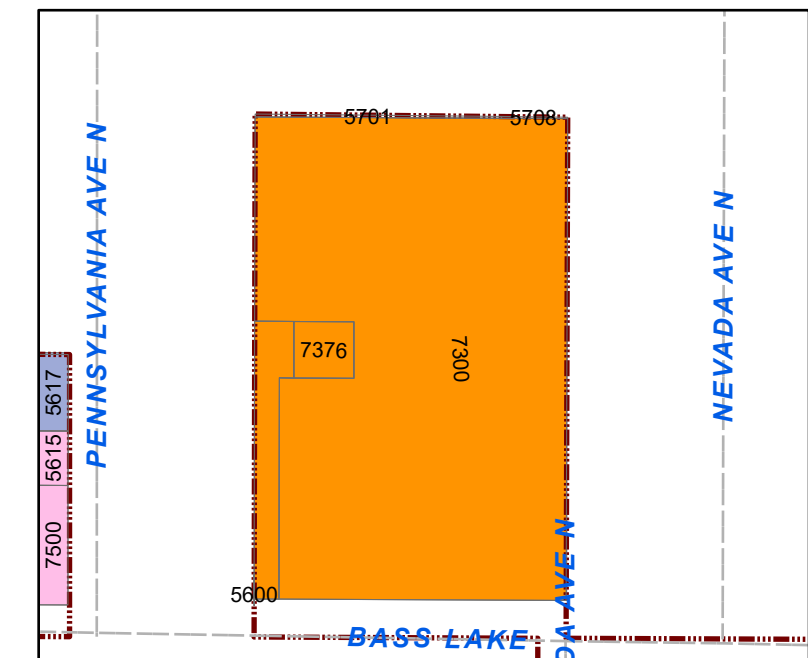

Inset 4

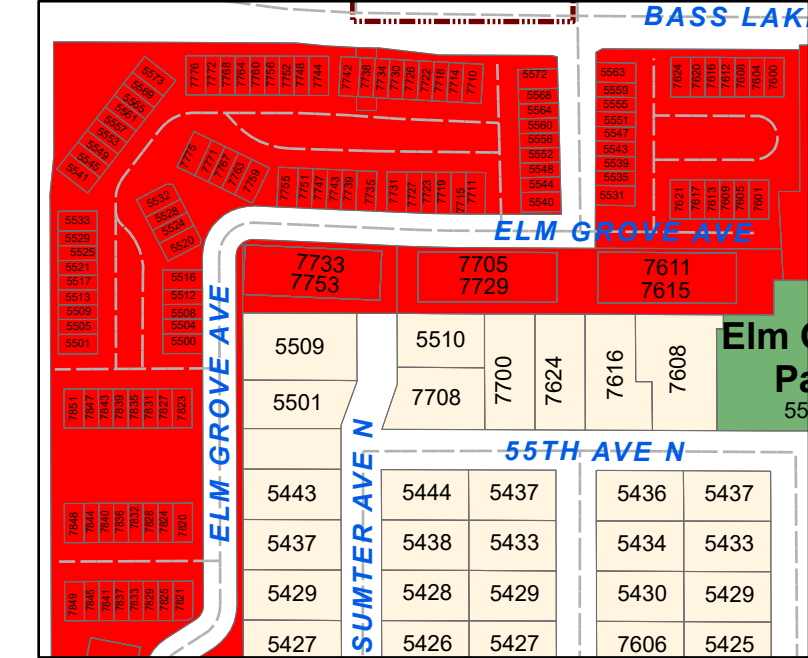

Inset 5

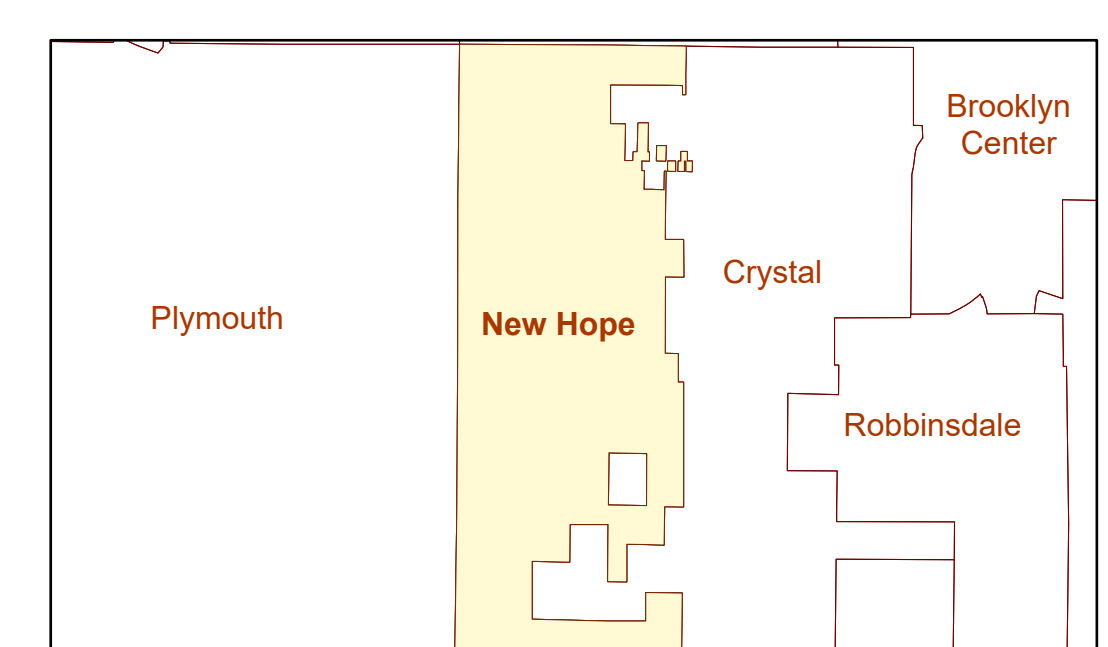
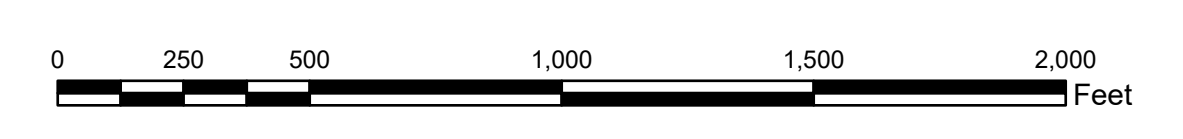
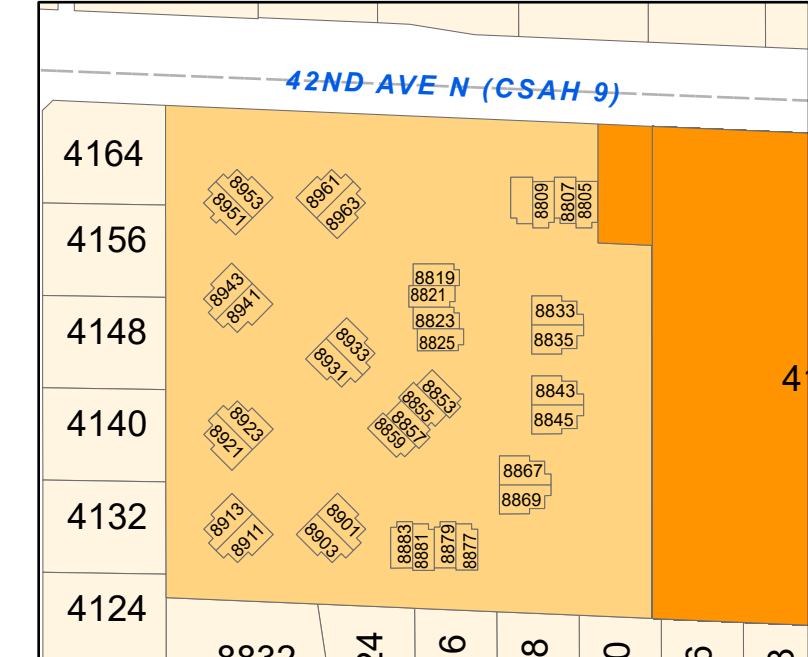

Disclaimer: Stantec assumes no responsibility for data supplied in electronic format. The recipient accepts full responsibility for verifying the accuracy and completeness of the data. The recipient releases Stantec, its officers, employees, consultants and agents, from any and all claims arising in any way from the content or provision of the data.

Revised: 2024-01-02 by: amerson  
V:\1938\Clients\New\_Hope\Projects\Pro\Zoning\Zoning.docx